

INNOFADER PNP

SAFETY:

Make 100% sure that the mixer power is OFF before you plug in the Innofader. Make sure that no part of the Innofader PNP directly touches the mixer. To be safe, use a piece of paper or other insulator under the Innofader main body as protection. In high static environments, please make sure to touch the mixer case before installation. **If you want to reinstall the Innofader PNP into another mixer, please make sure to reset it to the TEST mode and repeat the following Installation procedure.**

TEST, CHECK, and GO!

TEST:

Make sure Innofader is in "TEST" mode as shown here by "Jumper Installed": Find which of the 4 below cables works for your mixer.

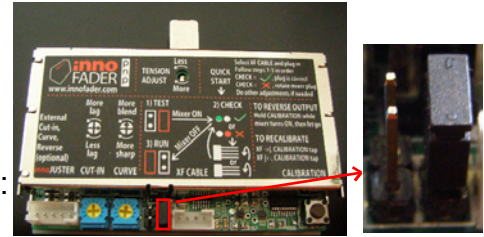

^ Jumper installed

1) 4 pin large (.254" spacing). Examples: Vestax PMC mixers, Stanton SA and SK mixers, Mackie d.2

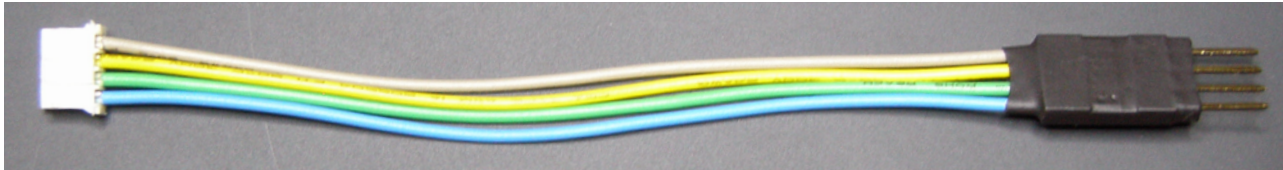

2) 4 pin small (.200" spacing). Examples: Numark IDJ2



3) 3 pin small (.200" spacing). Examples: Pioneer DJM-800/900, Korg Zero4, Urei 1601

***Please also use this cable for 6 pin crossfader connections and along with other matching cables below;
For Numark DXM / X series mixers, use pins 1, 2, 3 as shown

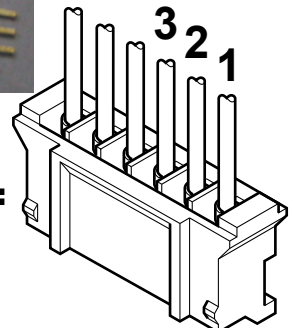
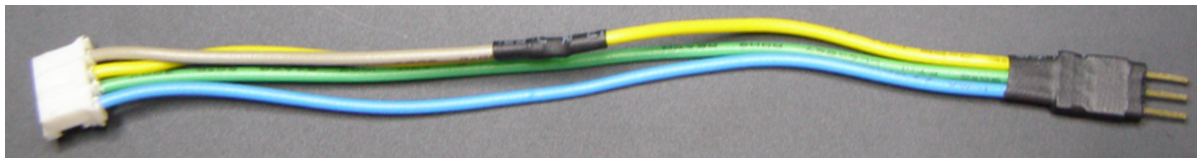

NUMARK DXM / X SERIES CONNECTOR:

4) P&G cable. Examples: All Denon Flex Fader mixers (DN-X600, DN-X1600, DN-X1700), Rane Empath

NOTE: Make sure you connect this cable together with the 3 pin small cable as shown below.



Now connect one end of the cable to the mixer and the other end to your mixer:

3 pin small, 4 pin small or large

P&G Cable + 3 pin small cable

Connect to mixer

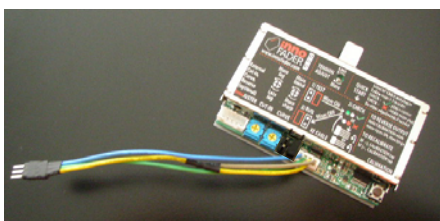

OR

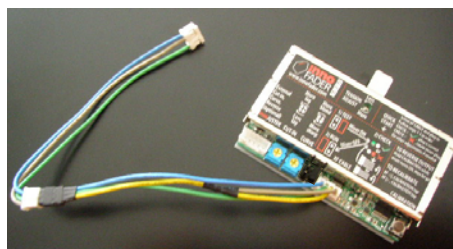

THEN

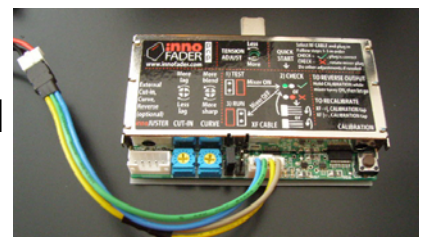

More on the other side ----->

CHECK:

Turn on the mixer power and check the LEDs just to the right of the InnoFader PNP 4 pin connector. If the red LED lights up, simply reverse the connector.

CABLE IS BACKWARDS HERE

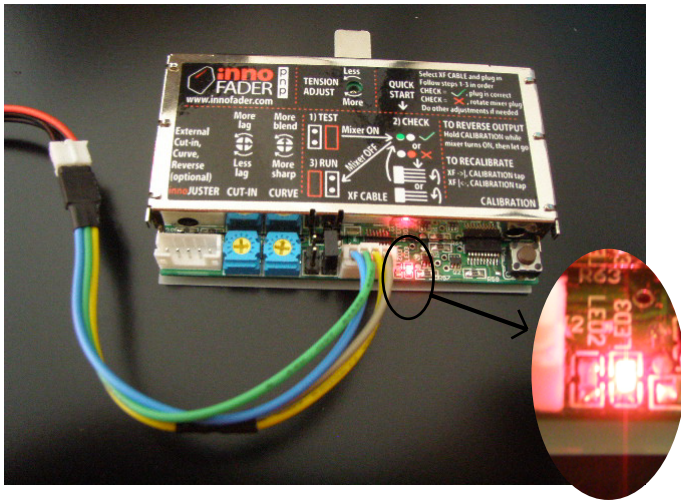

CABLE IS GOOD HERE!

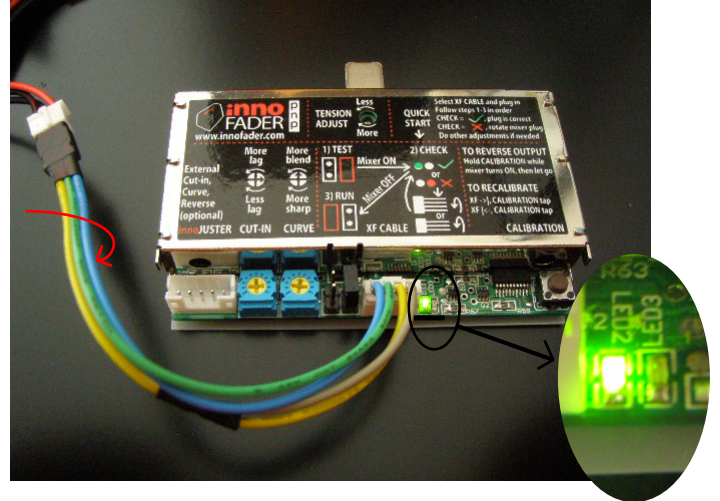

GO: Power the mixer off, move the jumper pin over, mount the Inno, and GO!

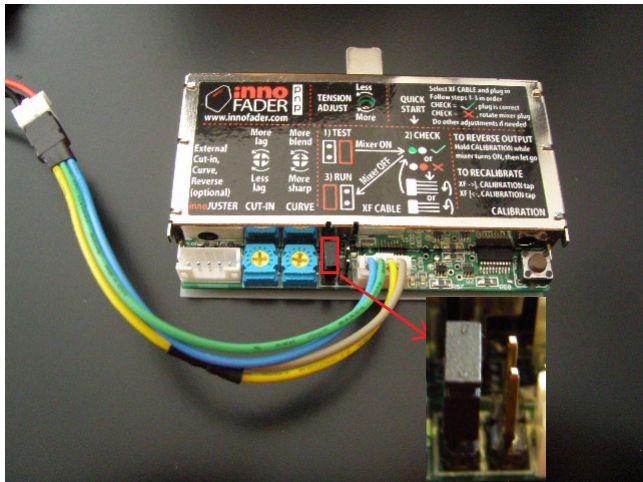

CONTACT AND LINKS FOR FURTHER READING:

Contact us if you have ANY questions about the installation. We're here to help you!

Mail to: support@audioinnovate.com

Interactive list of InnoFader compatible mixers with mixer specific instructions:

<http://www.innofader.com/compatible.php>

General InnoFader instructions showing insulation and adjustments (cut-in, curve, and tension):

<http://www.innofader.com/fitting.php>

InnoFader PNP webpage:

<http://www.innofader.com/products.php?id=12>

For the Perfect Scratch:

CUT-IN: Turn a little to the right to get a tight cut, a little to the left if you want to allow more bounce.

If the mixer has its own cut-in or "lag time" adjustment, turn the InnoFader Cut-In all the way to the right.

CURVE: Turn a little to the right to sharpen the cut or get rid of the "dip in the middle". Turn a little to the left if the mixer curve is too sharp. Turn all the way to the right if you only want to scratch (but this will disable your mixer's external curve control, if it has one). If you still want to use your mixer's external curve control, leave the InnoFader's curve control somewhere near the middle.

CALIBRATION: With the mixer power on, start at the left, move the knob all the way to the right, press button, then move the knob all the way to the left, press button. ***Hold this button while powering on to reverse the output. This is useful for situations when fader reversal is difficult.

TENSION ADJUST: Right for more, left for less. Don't go too far left or it will grind!

LUBE: Apply to both rails and increase tension to work in the lube. Use the mini-tube taped next to the lube and DON'T OVERLUBE! LESS IS BETTER!

