

FACTORY RESET - EVERYTHING GOES BACK TO NEW

Just in case you lost track of your settings, do this to restart from the beginning
Everything goes back to the way it was when you first opened the box!

1) Knob starts all the way left.
Press and hold the button.

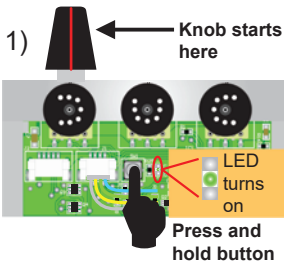

2) Slide the knob to the right.
Keep holding on to the button.

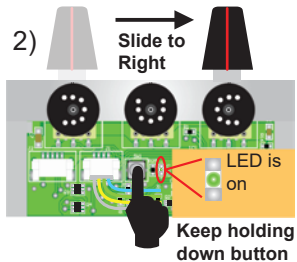

3) Slide the knob all the way back to the left.
Keep holding down the button.

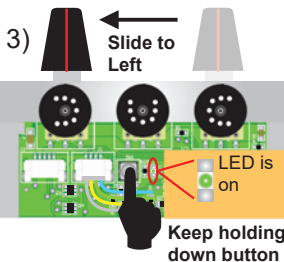

When you are done, the PNP3 will reset itself and go through a sequence of flashing LEDs.

If this step was done correctly, the LED will flash brightly 12 times and then stop after you release your finger.

Please repeat this step if any of the flashes are dim OR there are more than 12 flashes total!

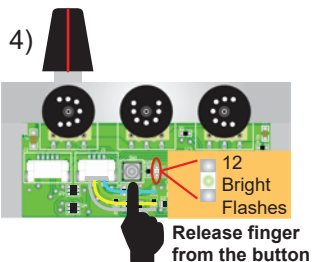

12 LED FLASH SEQUENCE AFTER FACTORY RESET

If you did the adjustment correctly, immediately after calibration and every time you power on the Innofader, you'll see the following LED flash pattern. **No DIM LEDs...**
DIM LEDs indicate a setting that is different from the factory programming

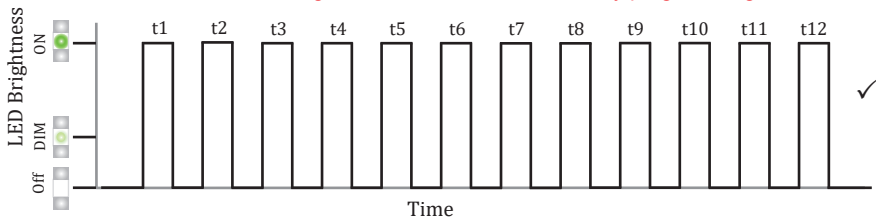

If you did NOT do the FACTORY RESET correctly, the LED flash pattern will still show the settings that remain on the fader. So for example, if you recalibrated the Innofader PNP3 or shifted the cut points and the FACTORY RESET didn't work, this happens:

